

DIY FLATPACK INSTALLATION GUIDE

Before you begin - Using the app on your smart phone, scan this QR for a step-by-step installation video

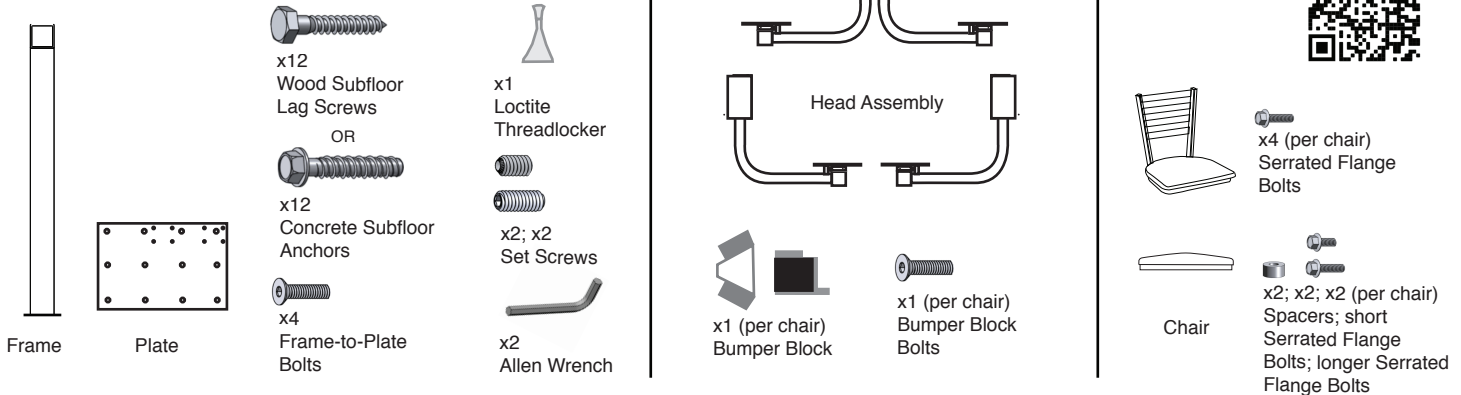

INSIDE THE BOXES YOU'LL FIND:



PRODUCT SPEC'S & REQUIREMENTS

- ✔ Is the distance from the floor to the bottom of the counter-top 34 1/2"? **Img 1 & 2**
- ✔ Do you have a minimum of 25" of countertop space for each chair? **Img 3 & 4**
- ✔ If you are coming off a wall, you will need to start 9" from the wall and then allow a minimum of 25" spacing for each chair along the countertop. **Img 3**
- ✔ Do you have 10"-12" of counter-top overhang? **Img 1 & 4**
- ✔ The product frame will be mounted to the floor into the wood/concrete subfloor where no radiant heating, plumbing or electrical is located.
- ✔ A 6" footrest will need to be built to cover the steel plate.
- ✔ This product is for indoor-use only.

Note: Depending on the chair style and size of chair, the chair backs may collide when opened. Powder-coat finishes are very durable but chips or damage may occur if chairs routinely collide. We recommend that the chairs be opened wide enough for the person to be seated, as opposed to opening them all the way.

FAILURE TO FOLLOW THESE INSTRUCTIONS COULD RESULT IN DAMAGE TO THE PRODUCT, YOUR FLOORING, CABINETS AND/OR COUNTERTOP AND VOID ANY WARRANTY

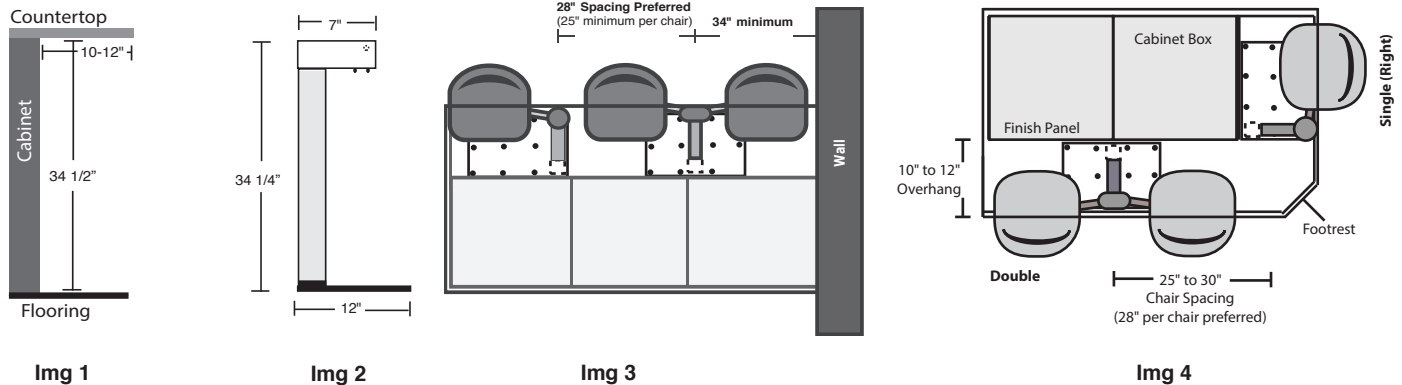

TOOLS NEEDED

Power Hand Drill (wood subfloor - 7/32" bit) or **Hammer Drill** (concrete subfloor - 3/8" bit) for pre-drilling holes to mount the plate to the subfloor.

9/16" **Ratchet Wrench** or **Impact Drill** to secure Frame Plate into subfloor with wood lag screws or concrete anchors.

3/8" **Wrench** to secure the bolts to the chair.

Torque Wrench to set Frame-to-Plate Bolts to 20 foot lbs. (3/16" Hex)

1. BOLT FRAME TO PLATE & THREAD SET SCREWS

Place the Frame onto the Plate in the Double or Single position. (Note: the Plate is double-sided. If you need the Frame to be on the other side, simply flip the Plate.) **Img 5**

Apply a drop of Loctite to each of the Frame-to-Plate Bolts (4) and place in the Frame holes and tighten with the allen wrench. Tighten to 20 foot pounds with the torque wrench. **Img 6**

Thread the 3/8x1/2" (2 - taller) set screws into the corner holes of the Frame receiver half way. Thread the 3/8"x3/8" (2 - shorter) set screws into the bottom and side holes of the Frame receiver about half way. **Img 7**

2. MEASURE AND PLACEMENT (see sample layouts)

Measure the length of your countertop and your cabinet panel to determine the placement of the Frames. In general, we recommend 28" per chair (See Design Layout Samples) or 56" from center of Frame Receiver to center of Frame Receiver for two doubles. Note: If your Chair will be mounted next to a wall or on a corner with two Chairs, you'll need 34" of space from the wall or from the countertop corner to center of Frame Receiver.

3. PRE-DRILL HOLES AND SECURE LAG SCREWS/ANCHORS

To secure the Frame to a Wood subfloor, pre-drill holes through the Plate with a 7/32" drill bit. To secure the Frame to a Concrete subfloor, use 3/8" drill bit as described in the adjacent instructions. Locate the correct lag screws/anchors (12) for the type of subfloor (Wood or Concrete) you're working on. Using a 9/16" ratchet, tighten lag screws (12) into the floor until snug (Note: make sure not to over tighten or it could strip the screws.) You can also use an impact drill.

4. BUILD FOOTREST (FIND TUTORIAL at https://www.youtube.com/watch?v=B_bbCvrgVWU)

The footrest covers the base of the Frame Plate. It should be a finished height of 6" from the floor. **Img 8**

5. SECURE BUMPERS ON HEAD ASSEMBLY

Secure Bumper Block on Head Assembly. Cut the zip tie holding the swing arms together. Lay the Head Assembly down and rotate the arms so you can see the threaded holes in the arm stop collar (lower collar under bronze bushing). Put a drop of LOCTITE onto the Bumper Block bolt and screw it into the lower collar (see orientation). Tighten all the way with an allen wrench. (Each arm needs a Bumper Block) **Img 9**

6. MOUNT HEAD ASSEMBLY AND TIGHTEN SET SCREWS

Lift the Head Assembly and slide it into the Frame receiver. **Img 10** Using an allen wrench, tighten the lower corner set screws (2) until the Head Assembly square tubing is tight against the top and left side of the Frame receiver. Tighten the bottom set screw (1) then the right side set screw (1). **Img 11** Slide the cover up by slightly flexing the ends apart on the backside. Keep about 1/8" of space from the underside of your countertop to account for any flex.

7. ATTACH SEATS

Place the chair onto the seat plate. Using a 3/8" wrench, tighten all four bolts. **Img 12** See 3 degree pitch adjustment instructions for Round Wood Chair. **Img 13**

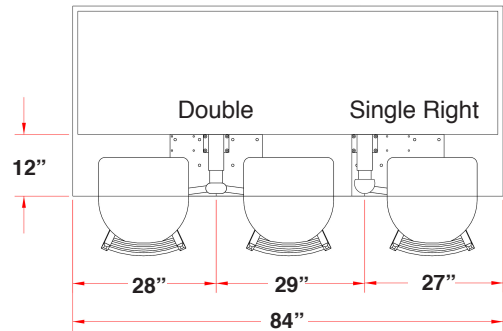
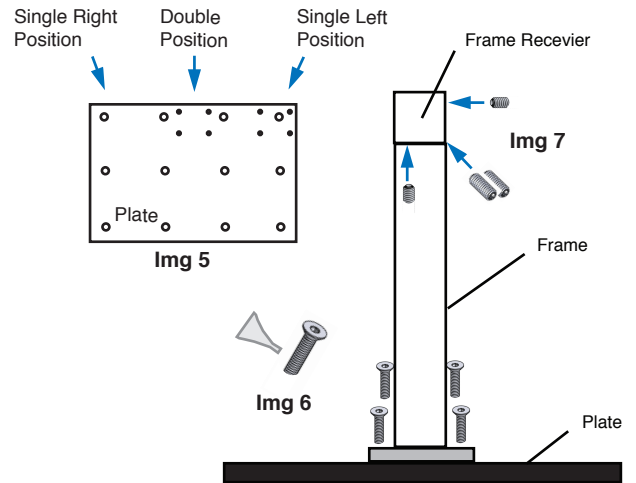

Concrete Titen HD® Anchor Installation: (1) Always wear safety glasses; (2) Use only solid carbide-tipped bits meeting ANSI B212.15-1994 (3/8" drill bit for 3/8" anchor); (3) Drill a hole in the base material to the specified embedment depth plus 1/4" to allow the thread tapping dust to settle, and blow it clean using compressed air (Alternatively, drill the hole deep enough to accommodate embedment depth and the dust from drilling and tapping). (4) Insert the anchor through the frame and into the hole. (5) Tighten the anchor into the base material until the hex-washer head contacts the frame.

Caution: Use a Titen HD® screw anchor one time only — installing the anchor multiple times may result in excessive thread wear and reduce load capacity. Do not use impact wrenches to install into hollow CMU. Oversized holes in base material will reduce or eliminate the mechanical interlock of the threads with the base material and reduce the anchor's load capacity.

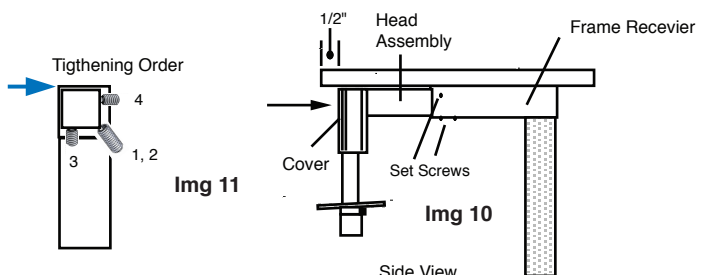
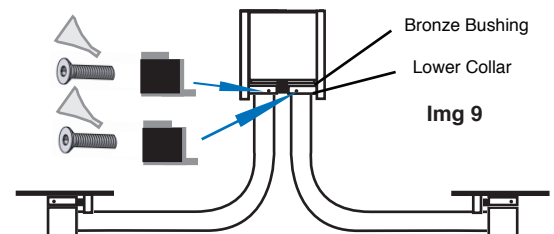
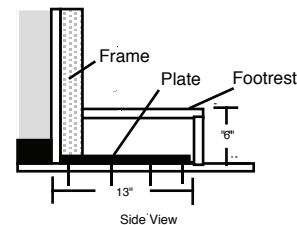
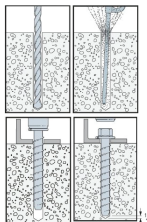

DIY FLATPACK LAYOUT SAMPLES

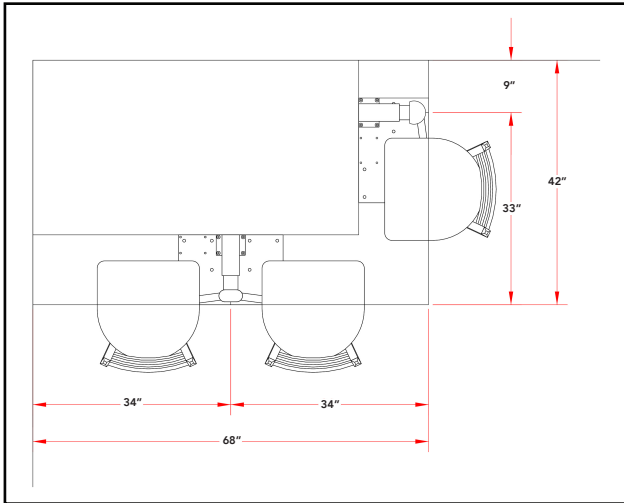

1 Double Chair Unit, 1 Single Left Chair Unit

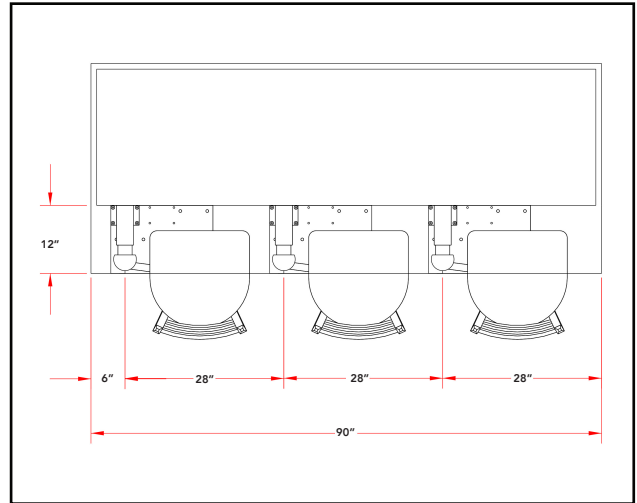

3 Single Right Chair Units

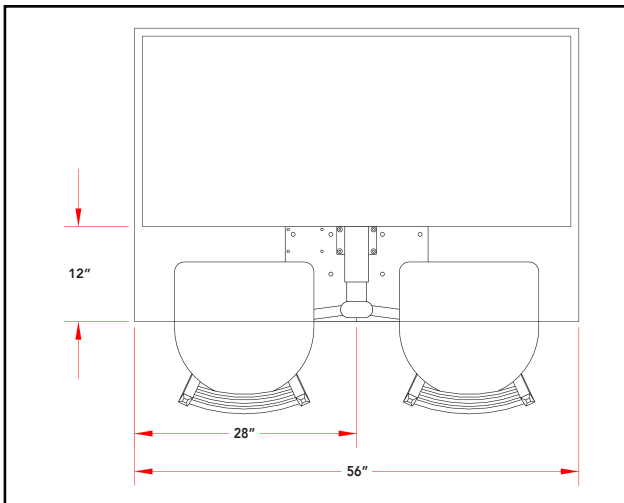

1 Double Chair Unit

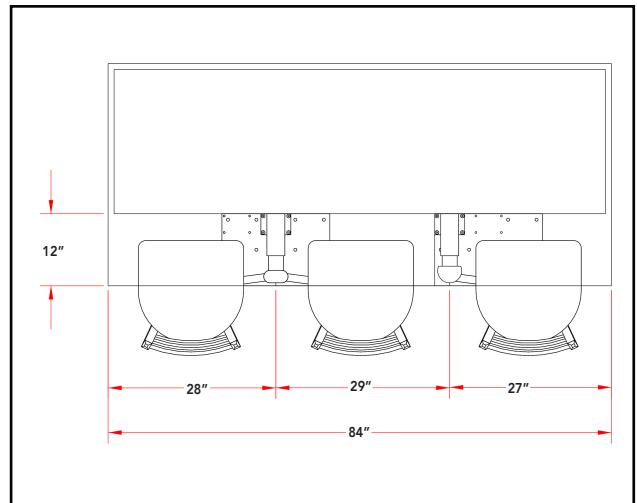

1 Double Chair Unit, 1 Single Right Chair Unit

DIY FLATPACK LAYOUT SAMPLES

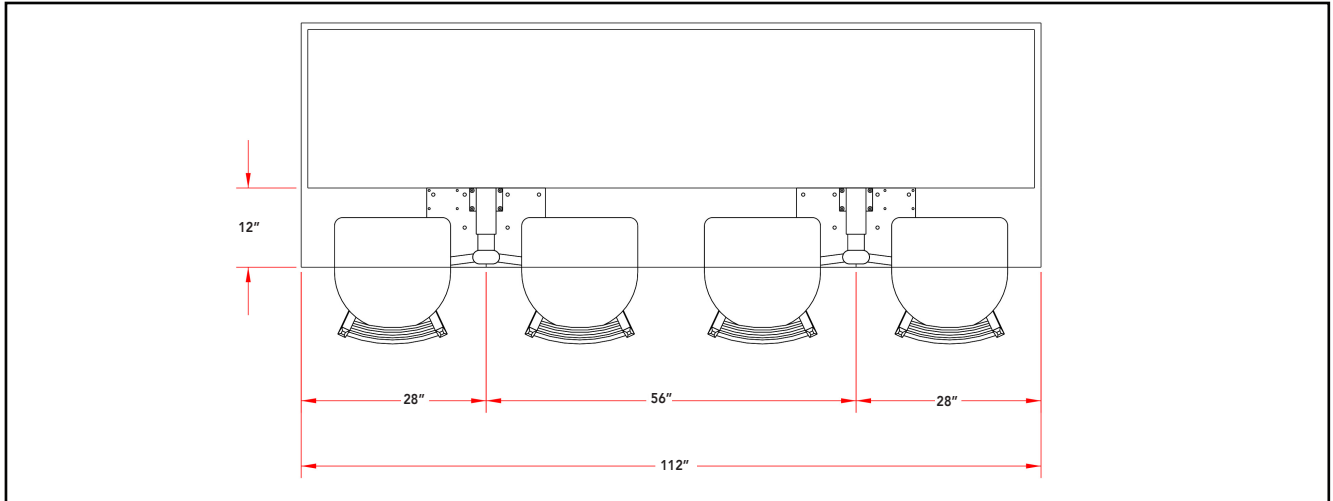

2 Double Chair Units

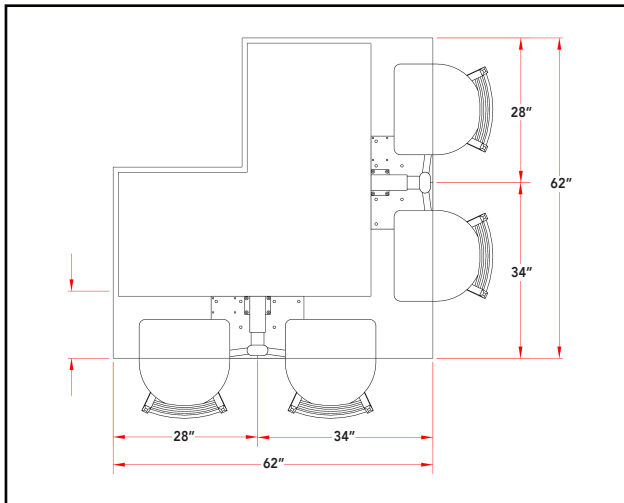

2 Double Chair Units

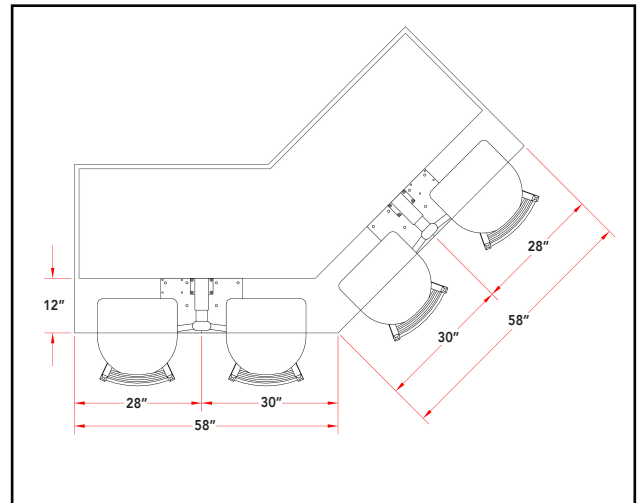

2 Double Chair Units